

Applications:

Make, Model, Year			Engine Code
Jaguar	F- Type Convertable	2013 TO 2018	3,0 LT
	F- Type Coupe	2014 TO 2018	AJ- 126/306PS
	XE	2015 TO 2018	AJ
	XF	2009 TO 2018	306PS
	XFR	2009 TO 2015	5,0 LT
	XFR-S	2013 TO 2015	AJ-133/508PS
	XJ	2010 TO 2018	AJ-133/508PN
	XJR	2013 TO 2018	508PN
	XK8	2009 TO 2015	50PS
	XKR	2009 TO 2015	
	Discovery 4/ Discovery	2009 TO 2018	
	Range Rover	2009 TO 2018	
Land Rover	Range Rover Sport	2009 TO 2018	

Our products are designed to be used correctly and with care for the purpose for which they are intended. No liability is accepted by the Tool Connection for incorrect use of any of our products, and the Tool Connection cannot be held responsible for any damage to personnel, property or equipment when using the tools. Incorrect use will also invalidate the warranty.

If applicable, the applications database and any instructional information provided has been designed to offer general guidance for a particular tool's use and while all attention is given to the accuracy of the data no project should be attempted without referring first to the manufacturer's technical documentation (workshop or instruction manual) or the use of a recognised authority such as Autodata.

It is our policy to continually improve our products and thus we reserve the right to alter specifications and components without prior notice. It is the responsibility of the user to ensure the suitability of the tools and information prior to their use.

7415_Instructions_V5

Guarantee

If this product fails through faulty materials or workmanship, contact our service department direct on: **+44 (0) 1926 818186**. Normal wear and tear are excluded as are consumable items and abuse.



Distributed by The Tool Connection Ltd

Kington Road, Southam, Warwickshire CV47 0DR
T +44 (0) 1926 815000 **F** +44 (0) 1926 815888
 info@toolconnection.co.uk www.toolconnection.co.uk



LASER®

Crankshaft Pulley Holding and Removal Set JLR 3.0L (V6) & 5.0L (V8)



A set of tools required for the removal of the front crankshaft pulley (Crankshaft Vibration Damper) fitted to the Jaguar and Land Rover 3.0lt V6 and 5.0lt V8 petrol engines.

The crankshaft pulleys used on these engines are tightened to 200 Nm + 270 degrees so are very tight to undo and must be held by a substantial holding tool which the kit provides. Also included in the kit are the puller component's required to remove the pulley without damage.

Note: An axle stand is required when used with the engine in the vehicle.

IMPORTANT: Ensure the force screw is well lubricated with Molybdenum Disulphide Grease.

7415 - Crankshaft Pulley Set - JLR V6/V8

Item	Comp	OEM No.	Description
A	C888	303-1437	Crankshaft Damper Holding Tool
B	C889	303-1438	Long Series Socket- Crankshaft Damper Bolt
C	C891	303-1439	Crankshaft Damper Removal Plate
D	C891	303-1439-01	Bolts for 303-1439
E	C892	303-1440	Crankshaft Damper Remover/Fitting Force Screw
F	C890	303-1441	Crankshaft Damper Remover/Fitting Force Nut

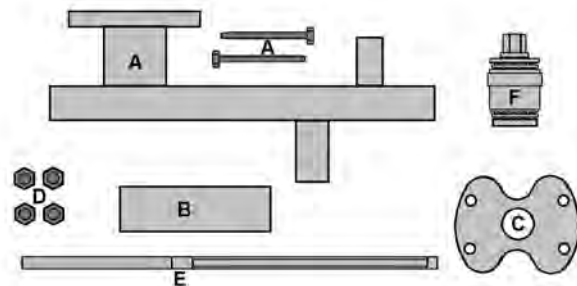

The following instructions are for guidance only. Please refer to OEM derived data such as the vehicle manufacturers' own data or Autodata. The use of this Crankshaft Pulley Set is purely down to the user's discretion and Tool Connection Ltd. cannot be held responsible for any damage caused what so ever.

NOTE: Component A is used to lock and hold the front crankshaft pulley, the flywheel should also be locked via the flywheel to ensure the crankshaft cannot move. Always refer to OEM instructions for use.

WARNING: The crankshaft pulley fixing bolt can have a left or right hand thread dependent on engine model. Please check OEM data for the engine being worked on to confirm.

IMPORTANT: Ensure the force screw is well lubricated with Molybdenum Disulphide Grease.

Fixing Bolt heads marked 10.9 = Right Hand Thread

Fixing Bolt heads marked 12.9 = Left hand Thread

Instructions for use

Component A/B = Holding Tool and socket.

- Remove 2 of the pulley fixing bolts as shown



- Mount the holding tool (A) as shown and use a suitable axle stand to hold the holding tool from turning.

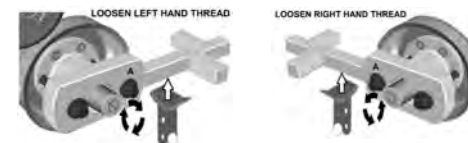

Component C, D, E & F- The Pulley Puller

- Remove 2 of the pulley fixing bolts as shown.

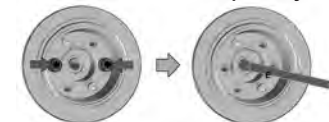

- Fit Component (F) as shown over component (E).



- Fit components (C) and (D) as shown wind the nut of (F) counter clockwise as shown to pull the pulley off.



Pulley Fitting:

NOTE: refer to OEM instructions for use of RTV sealant on the crankshaft pulley keyway

- Fit the crankshaft pulley using components C, D E & F as shown.



- When fitting the central bolt use components (A) & (B) to hold the pulley against the torque of tightening the bolt

NOTE: Refer to OEM instructions for the torque setting required.